

COVER  POOLS®

AFTERMARKET AUTOMATIC POOL COVERS





COVER-POOLS HAS YOU COVERED

If you already have a pool, or if you're planning to build one, a Cover-Pools automatic pool cover is the best way to safeguard loved ones, save money on heating costs and chemicals and protect your investment.

Find out for yourself what delighted pool owners all over the world have already discovered – our automatic pool covers are the finest, safest, and easiest pool cover you can use or buy.

WITH A POOL COVER, YOU GET PEACE OF MIND

With a Cover-Pools® automatic pool cover you get peace of mind with the simple turn of a key. In under a minute your pool is easily covered or uncovered. Your Cover-Pools cover acts as a “horizontal fence” for your pool, preventing access by children, pets, and uninvited visitors. And while there’s no substitute for proper supervision, your pool can be protected even when you’re not around. It’s a safety barrier that no pool should be without.

Designed for Safety

Cover-Pools covers are tested and listed by Underwriters Laboratories (UL), an independent Nationally Recognized Testing Laboratory (NRTL), as being in conformance with the applicable requirements of performance & safety standards such as ASTM F1346-91, published by the American Society of Testing and Materials (ASTM).*

Follow all safety and warning notices found in the owners manual.

PROTECT YOUR POOL AND YOUR LOVED ONES

*ASTM F13496-91: Standard Performance Specification for Safety Covers and Labeling Requirements for All Covers for Swimming Pools, Spas and Hot Tubs



WARNING:

Do not walk or stand on cover
except in an emergency.





A Cover-Pools cover extends your swimming season by reducing heat loss.

A POOL COVER SAVES UP TO 70%* ON OPERATING COSTS

The U.S. Department of Energy states* that a pool cover is “the single most effective means of reducing pool heating costs.”

Saving you up to 70% on pool operating costs, a pool cover also helps prevent the evaporation of both precious water and expensive chemicals. It even acts as a passive solar heater by capturing the sun’s radiant heat extending your swimming season.

At the same time, a pool cover keeps dirt and debris out of the pool, reducing cleaning, maintenance costs and overall wear on pool equipment. Cover-Pools covers have proven to be one of the best ways of reducing pool expenses all year long.



*<https://www.energy.gov/energysaver/swimming-pool-covers>



SAVINGS AND CONVENIENCE



Saves energy, adds heat.

A Cover-Pools cover dramatically reduces heating costs and extends your swimming season by acting as a giant solar collector.



Saves water and chemicals.

By reducing evaporation, your Cover-Pools cover cuts water loss and reduces the use of chemicals.



Saves cleaning.

Keep dirt, leaves, and debris out by simply keeping your pool covered.



Saves pool equipment, extends pool life.

With a covered pool, you keep the heat in and the dirt and debris out. Heaters and other pool equipment work less and last longer.



Saves money.

By saving heat, chemicals, cleaning, and extending equipment life, your Cover-Pools cover quickly pays for itself. You can save up to 70%* on operating costs, which is a great return on your investment.

*<https://www.energy.gov/energysaver/swimming-pool-covers>



For indoor pools, a cover provides the added benefit of eliminating the need for expensive dehumidification systems.

LET OUR TRACKS GUIDE YOU



Undermount track system



SnapTop™ track system

UNDERMOUNT TRACK SYSTEMS

Dual-Race Undertrack System

Undertrack is a perfect way to fully integrate the cover into the pool and deck. With an Undertrack installation, the tracks are concealed beneath the deck for the ultimate in smooth, worry-free operation.

Dual-Race Undertrack and Track Channel

For freeform pools with Undertrack, the channel makes it easy to construct deck-on-deck applications around any vinyl, fiberglass, or concrete pool.

Raised Dual-Race Track Channel

Intended for fiberglass pools, a channel can be placed on the top of the fiberglass pool, then have the deck built on the raised track channel. This is a good choice for freeform fiberglass pools.

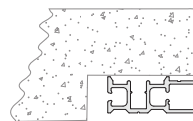

Undertrack design allows a variety of deck profiles.

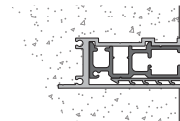

Undertrack with Dual-Race Track Channel

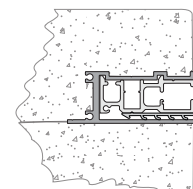

Deck-on-deck with Dual-Race Track Channel

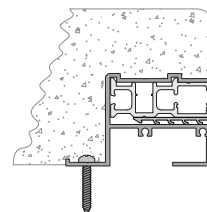

Raised Dual-Race Track Channel

DECK MOUNT TRACK SYSTEMS

SnapTop™ Track System

SnapTop track is a two-piece track system that conceals the screws from view and creates a smooth, streamlined track surface.

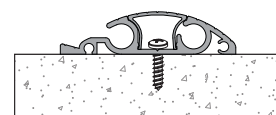

SnapTop Track



LEADING EDGE AND GLIDER

Round Leading Edge

The leading edge is designed to guide your pool cover across the water ensuring smooth operation and a strong, flush seal at the far-end pool wall. Each Cover-Pools pool cover comes standard with a round leading edge.



Round Leading Edge
(with optional bumper)

Square Leading Edge*

The optional square leading edge adds rigidity and a modern finish to your pool cover. The square shape reduces deflection making it easier to hide the leading edge and creates a better seal. It may also be wrapped in matching fabric for a more seamless look.

*Only available for pools up to 25' wide and applications using adjustable gliders.



Square Leading Edge
(wrapped with optional fabric)

Low Profile Rectangular Leading Edge**

Our smallest leading edge at 1 1/2" x 3 1/2" for a sleek modern finish that holds fabric with a built-in channel (can also be used with a fabric pocket). Our low profile rectangular design resists deflection in both vertical and horizontal directions while providing less deflection than competing leading edges of similar form.

**Only available for pools up to 16' wide.



Low Profile Rectangular Edge

Adjustable Glider and Dowel

The adjustable glider and dowel combination can incrementally adjust the leading edge height 3" above or below the track. The dowel is standard with most undermount track systems.



Glider & Dowel

PICK YOUR POWER

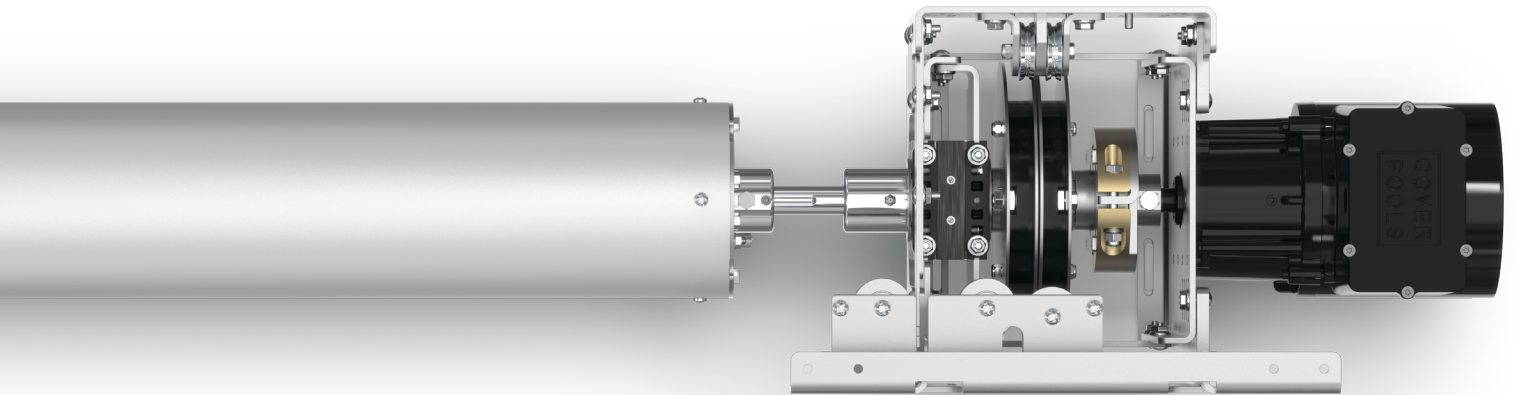

Original Full-Size T4 System

Stronger and smaller than any competitor's mechanism, the T4™ System is the only automatic pool cover system designed for stainless-steel cable – which is more durable and doesn't stretch or shrink like traditional rope.

- Fits 24" motor side box length
- Compatible on pools up to 80' long
- Custom 3/4 HP condensed motor with potted capacitor
- Includes separate mounting cradle
- Hydraulic option available
- Available with slip clutch or auto-shutoff*

T3 EVO™ Motor and Mechanism

Meet the brawn behind the beauty. Cover-Pools' exclusive mechanism is built especially for the pool environment. High-grade stainless-steel hardware components including the castings, extrusions, frame and brackets are specifically designed for today's mineral sanitizers to prevent corrosion and contribute to smooth operation and overall longevity of the system. Hydraulic option available.

- 3/4 HP Water Resistant Motor
- Slip Clutch*
- Corr-Resist™ Rope Reel System
- Stainless-Steel and Aluminum Mechanism
- Positive Shift System
- Corr-Resist Hybrid End Casting
- Marine-Grade Anodized Roller Drum

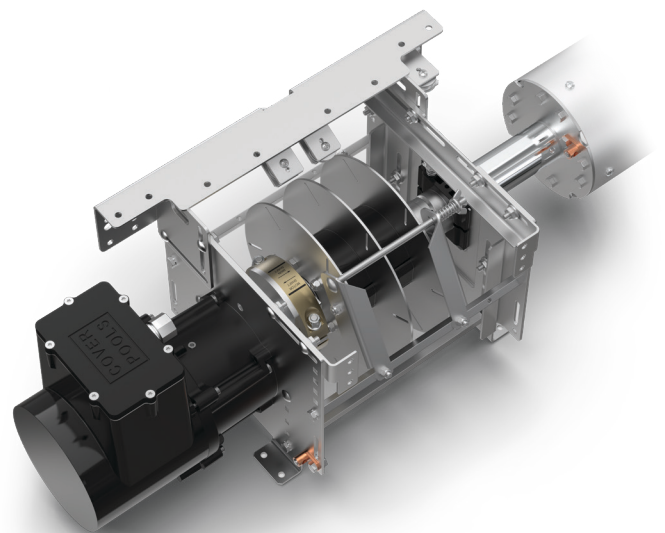

*Only available with electric system.
Slip Clutch not required with this option.

CONTROL SYSTEMS AND ACCESSORIES

The Intelligent Pool Cover

With Jandy® AquaLink® integration, your Cover-Pools® pool cover can control other pool features based on the position of the cover. When the cover is closed, AquaLink will deactivate any water features, limit chlorine output, and reduce pump runtime saving up to 50% on energy and chemicals.

By including a Cover-Pools Interface Board with the purchase of a Jandy AquaLink control system, you gain the following functionality:

- OneTouch™ controller shows whether the pool cover is open, closed, or partially open
- iAquaLink® app* shows whether the pool cover is open, closed, or partially open
- Salt chlorine production levels automatically adjust when the cover is opened or closed
- Water features, booster pump cleaners and pool lights will automatically shut off when the cover is closed
- Pump runtime automatically decreases when the cover is closed

This increased functionality will automatically:

- Save energy and operating costs
- Lengthen the life of the salt cell
- Avoid over chlorination of the pool
- Save water, protect the cover, and give pool owners extra peace of mind

*For safety, the app cannot operate the cover as the control must be mounted in view of the pool.

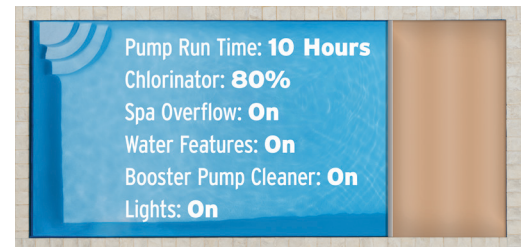

Pool Cover Open

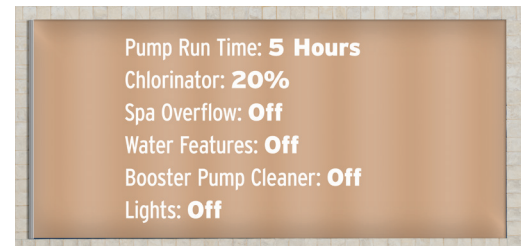

Pool Cover Closed

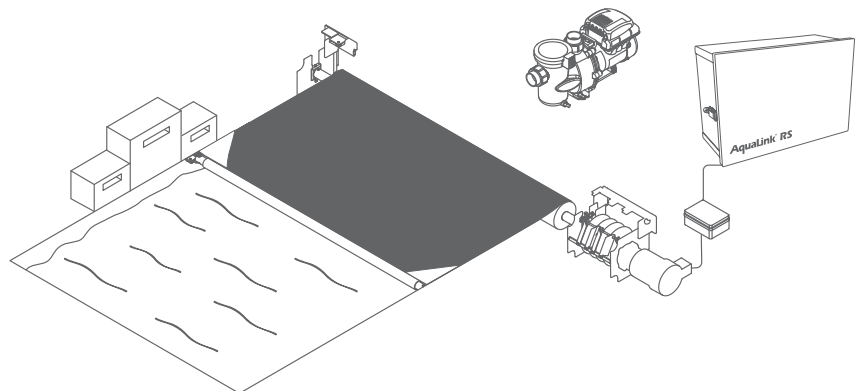

AquaLink®

Auto-Shutoff Control with Optional Accessory Board

The auto-shutoff control stops the cover automatically when it is fully opened or closed. The accessory board controls operation of water features, fiber optics, alarms, etc., in conjunction with opening and closing the cover.



Toggle Switch

Turn the toggle switch to cover or uncover your pool. To maintain a secure system, simply lock the toggle switch cover after you've covered the pool.



Key Pad

The code-accessed digital control system allows you to program up to four codes to create convenient and secure access to the system.

QUALITY, HIGH-TECH FABRICS



Quad-Core™ Fabric

Quad-Core™ laminated fabric uses an exclusive formula to create the strongest, most durable material designed specifically to stand up to the harsh elements of a swimming pool environment. Reinforced with a strong polyester mesh for strength and tear resistance, this high-performance vinyl-resin formula provides maximum durability in the swimming pool environment.

Quad-Core vinyl laminated fabric is also available in 35 special order colors to coordinate with any pool. Please see fabric samples when making color choice; Actual colors may vary.

Quad-Core Fabric



Pro-Coat™ Fabric

Pro-Coat™ fabric uses an enhanced coated formula that provides long-lasting durability with advanced tensile strength and exceptional resistance to abrasions and tears. Designed to stand up to the harshest elements, it is composed of a UV protectant and an anti-mildew inhibitor to deter premature delamination and deterioration due to chemicals or the sun.

Pro-Coat Fabric

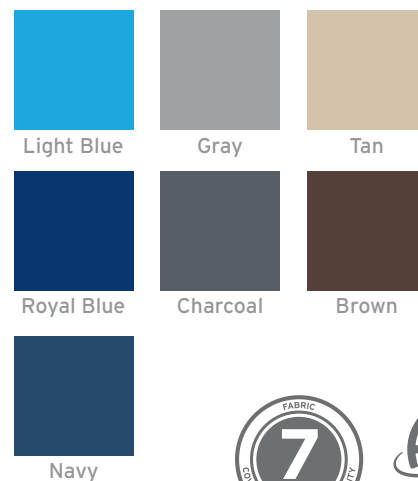

Strength meets or exceeds the ASTM F1346-91 minimum standard of 485 lbs per 3' radius.





WARRANTIES

With Cover-Pools® automatic pool covers, you get the assurance of over 55 years experience. We invented the automatic pool cover and we know that our covers will stand up to time and the elements. That's why our warranties are unparalleled.

- **Lifetime Limited Warranty:** Slip clutch, mechanism
- **7-Year Limited Warranty:** Fabric*, lid assembly, tracks, leading edge, and roller tube
- **3-Year Limited Warranty:** Motor, electrical, components, and cover pump
- **The only standard limited warranty covering saltwater pools**

*7-year fabric warranty as follows: First two years is full limited warranty, years 3-7 are prorated



